



# Interior Trim

## Replacement (Coupe)

Disassemble in numbered sequence.

### ⑤ QUARTER WINDOW TRIM

- To remove the trim, first remove the support strut and coat hanger.

Clip locations

### ② REAR TRIM PANEL

### ① MAINTENANCE DOORS

### ③ SEAT BELT ANCHOR COVER

### ④ QUARTER TRIM PANEL

- To remove the panel, first remove the seat belt, luggage light, and door sill molding.

### REAR SEAT SIDE TRIM

### ⑥ FRONT PILLAR TRIM

Clip locations

### ② KICK PANEL

### ① DOOR SILL MOLDING

# Interior Trim

## Replacement (2D H/B)

Disassemble in numbered sequence.

### ⑤ QUARTER WINDOW TRIM

- To remove the trim, first remove the quarter window latch mount cover and front seat belt.

### ③ SIDE SHELF

### ① REAR SHELF

Clip locations

Clip locations

### ④ QUARTER TRIM PANEL

- To remove the panel, first remove the door sill molding, rear seat, rear seat belt, luggage light, and door trim.

MAINTENANCE DOORS

### ② REAR TRIM PANEL

Clip locations

### ② DOOR TRIM

### ④ FRONT PILLAR TRIM

### ③ KICK PANEL

### ① DOOR SILL MOLDING

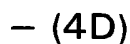

#### ④ ④ CENTER PILLAR UPPER TRIM

- ## 5 FRONT PILLER TRIM

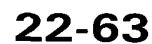

## Interior Trim

└ Replacement (4D H/B)

**Disassemble in numbered sequence.**



- On KS, KW, and KQ models, to remove the trim, first remove the upper anchor bolt from the rear seat belt.

### SIDE COMPARTMENT

### Clip locations

### TAILGATE TRIM PANEL

### Clip locations

### ① TAILGATE SILL MOLDING

## SIDE COMPARTMENT COVER

### ⑤ HEADLINER SIDE MOLDING

### ③ DOOR TRIM

② LUGGAGE COMPARTMENT  
SIDE TRIM PANEL

- To remove the panel, first remove the rear door sill molding and rear seat belt anchor bolt.

## DAMPER MAINTENANCE

### ③ DOOR TRIM

## 5 FRONT PILLAR TRIM

## 2 KICK PANEL

### 1 FRONT DOOR SILL MOLDING

**②② CENTER PILLAR LOWER TRIM**

#### ④④ CENTER PILLAR UPPER TRIM

- To remove the trim, first remove the upper anchor bolt from the front seat belt.

### ① REAR DOOR SILL MOLDING

# Front Seat



Replacement (Coupe, 2D H/B, and 4D)

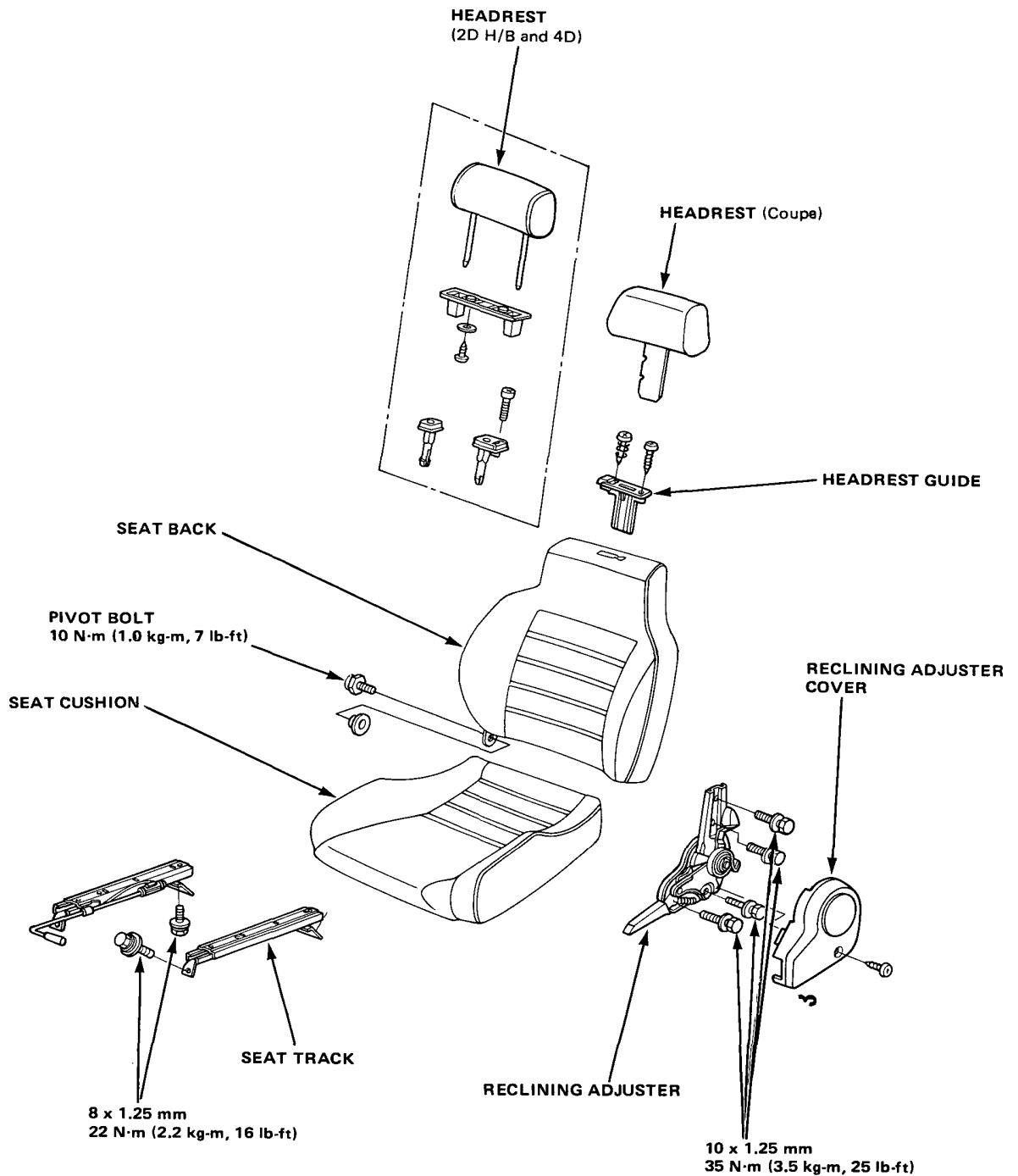

# Front Seat

Replacement (4D H/B)

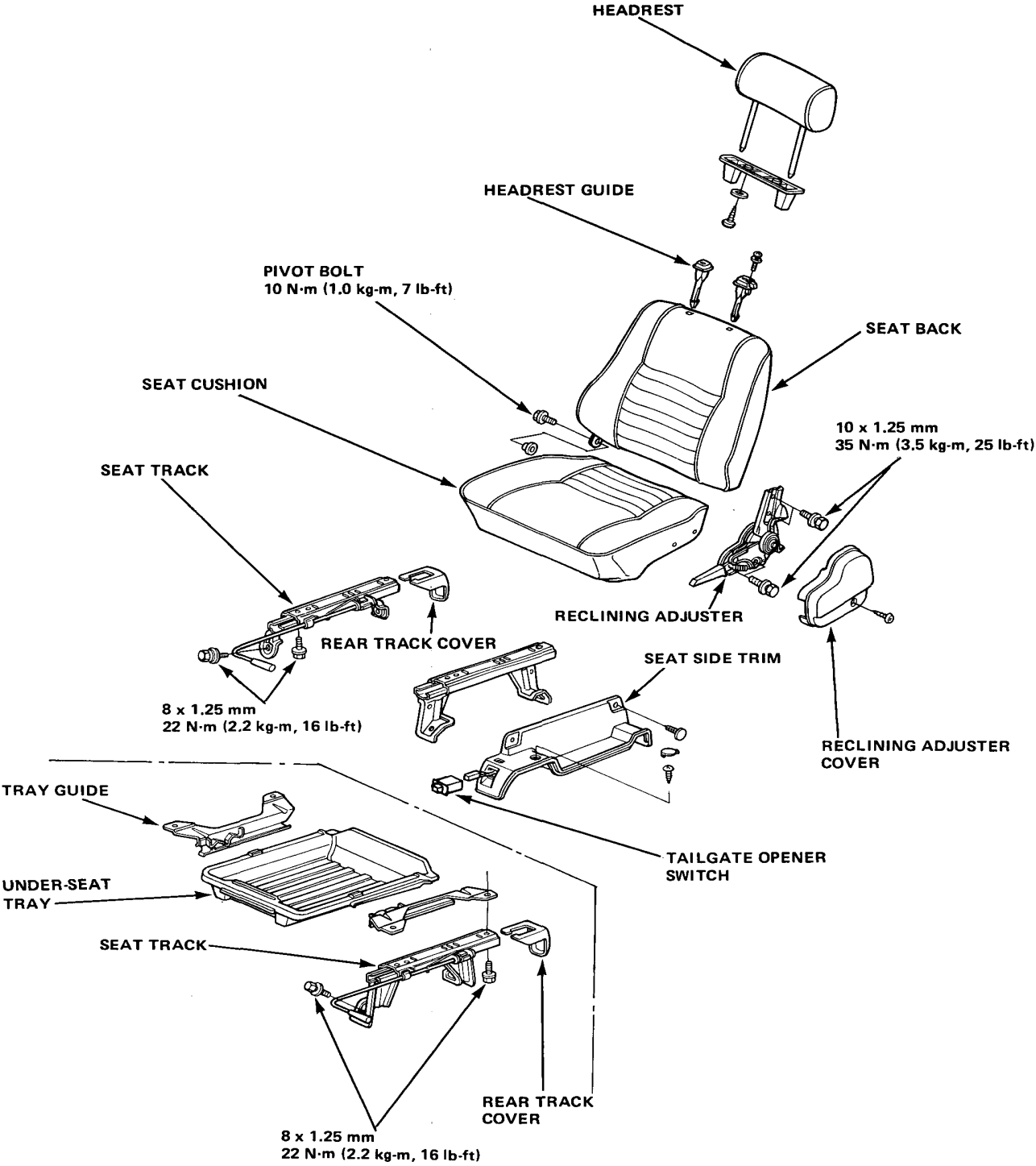



# Rear Seat

## Replacement (Coupe)

Disassemble in numbered sequence.

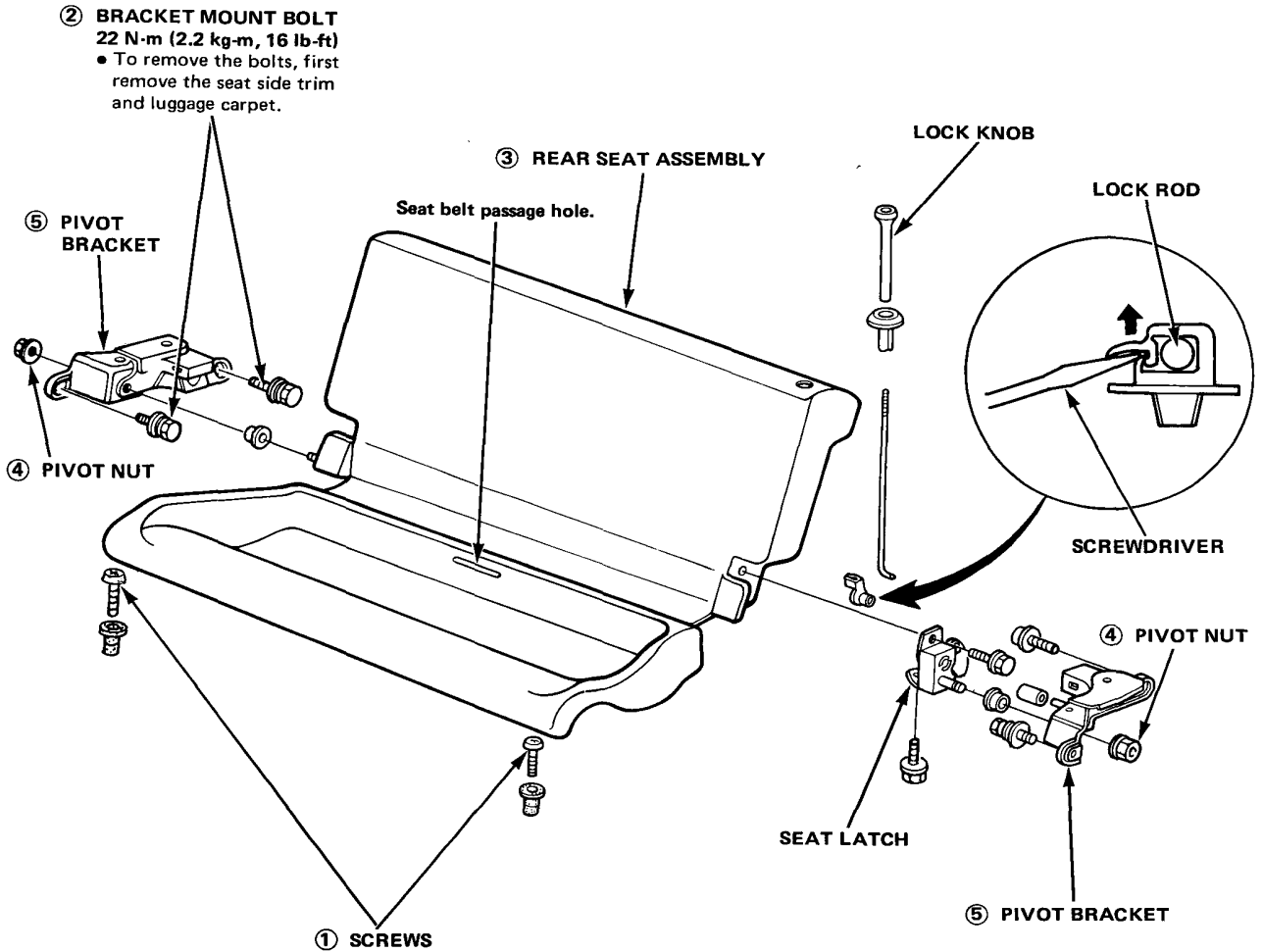

# Rear Seat

## Replacement (2D H/B)

Disassemble in numbered sequence.

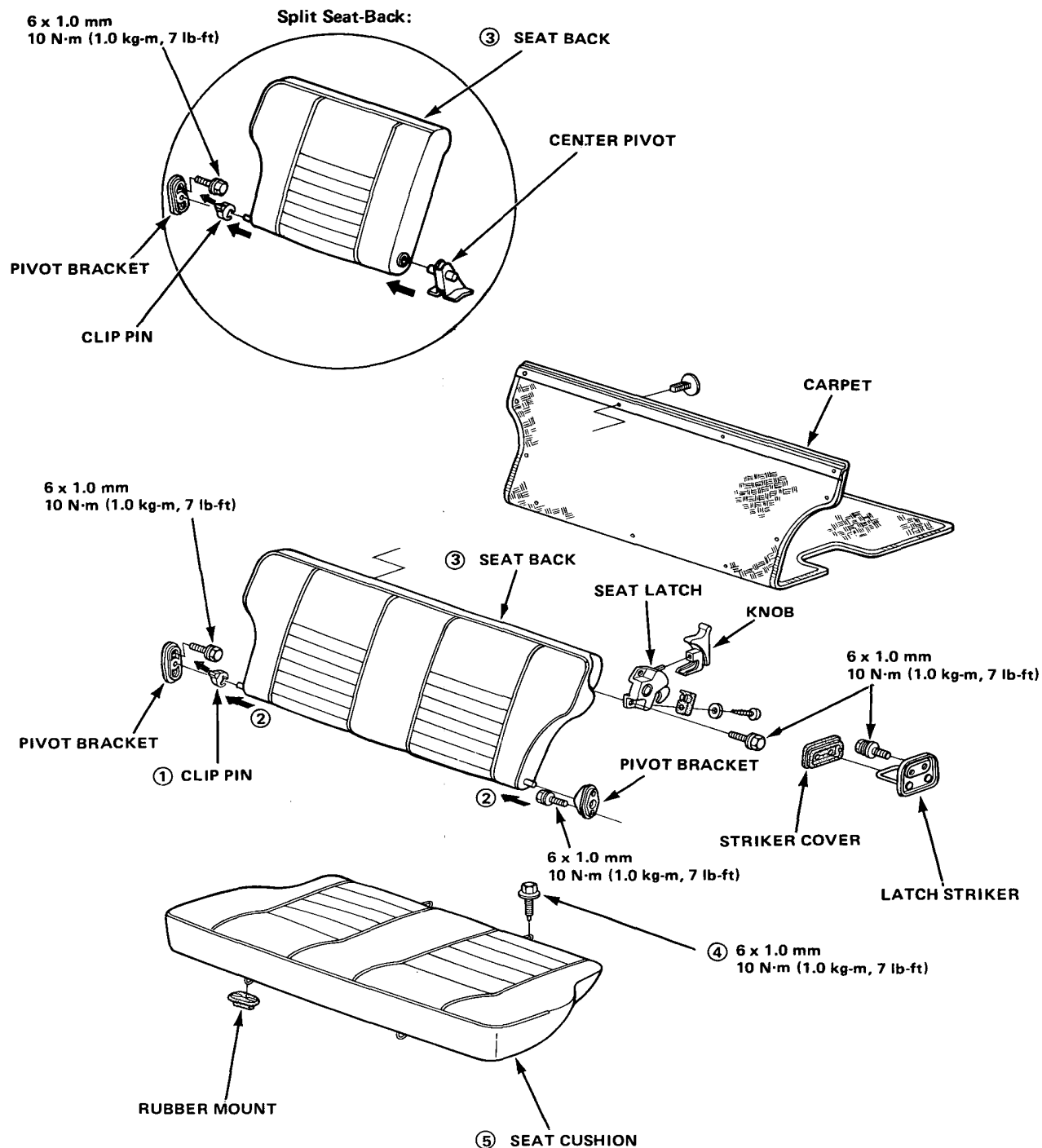





## Pully-adjustable Rear Seat:

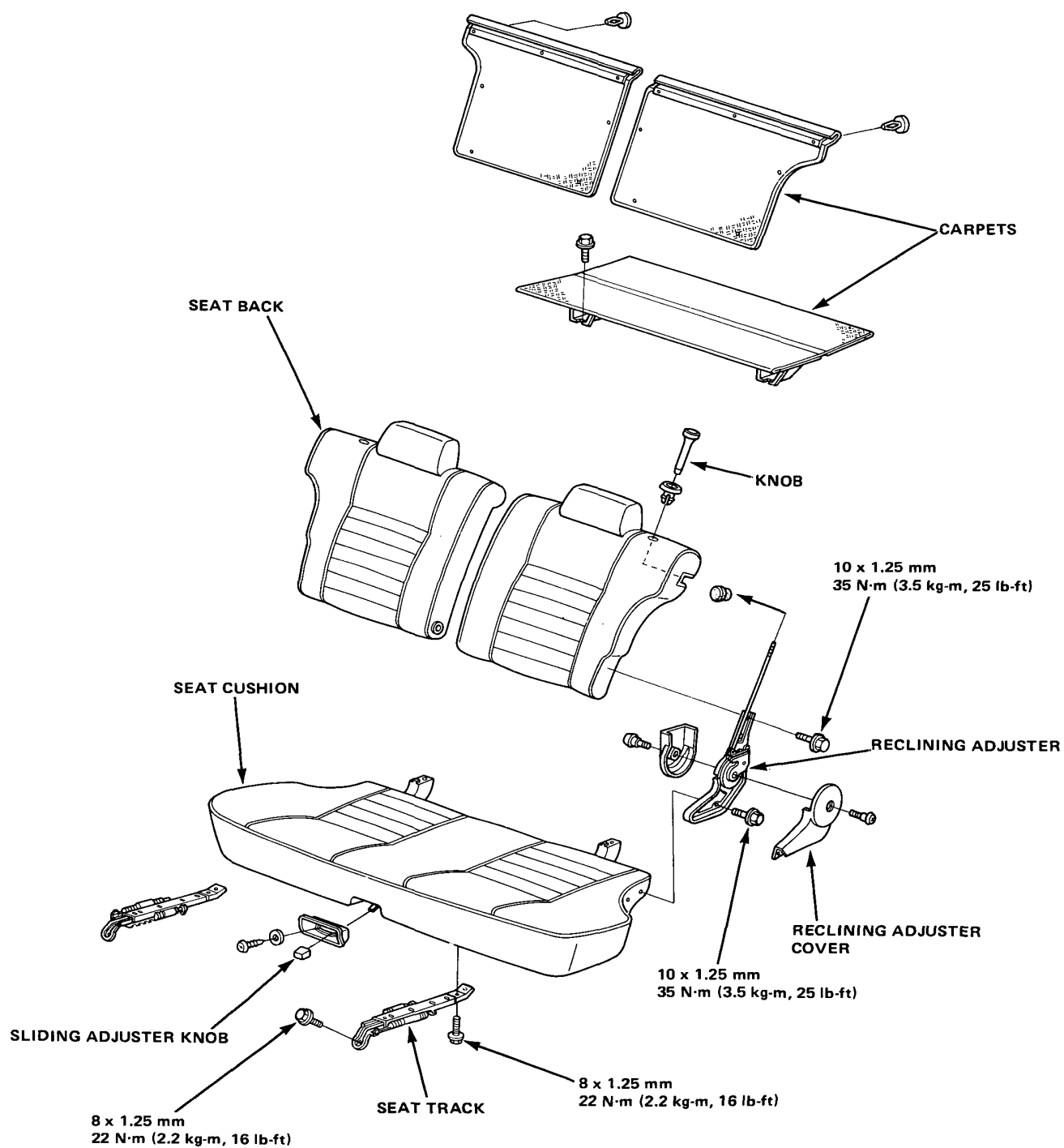

# Rear Seat

## Replacement (4D)

Disassemble in numbered sequence.

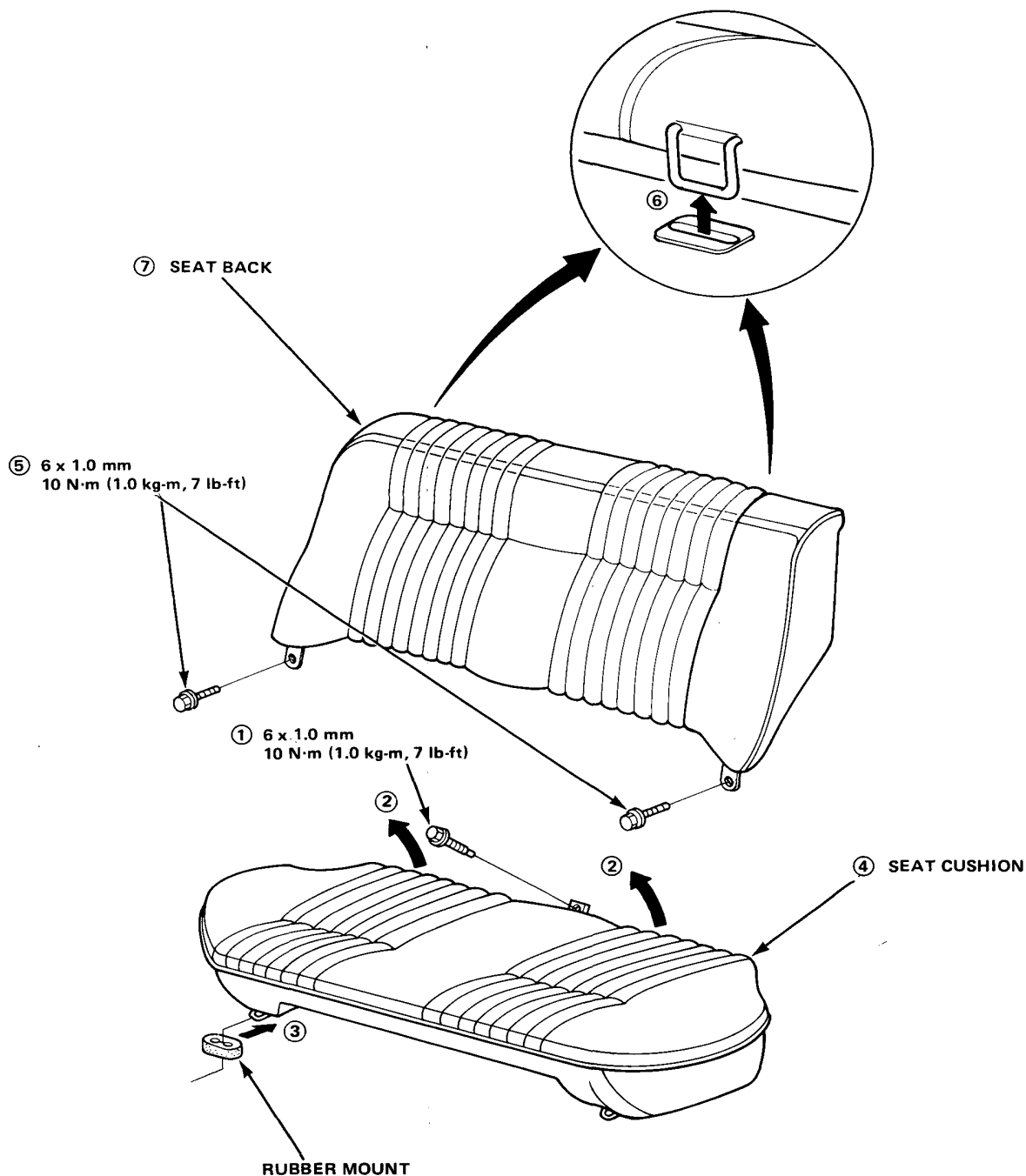



Diagram illustrating the assembly of a car seat, showing various components and their assembly sequence:

- HEADREST**
- SEAT BACK**
- CLIP PIN**
- SIDE PIVOT**
- SIDE PIVOT COVER**
- SPACER BUSH**
- SEAT CUSHION LATCH COVER**
- SEAT CUSHION LATCH**
- LATCH STRIKER**
- SEAT LATCH COVER**
- SEAT LATCH**
- KNOB**
- CARPET**
- CENTER PIVOT**
- SEAT BELT GARNISH**
- E-CLIP**
- LINK**
- ROD**
- SEAT HINGE**
- SLIDE KNOB COVER**
- SLIDE KNOB**
- MOUNT SCREW**  
To expose the mount push the button down way.
- CUSHION CARPET**
- HINGE COVER**
- SEAT HINGE BASE**
- BODY**

# Seat Cover

## Replacement

1. Separate the seat cushion and back.
2. Remove all clips on the rear of the seat, and separate the cover from the seat.

### Front Seat Back:

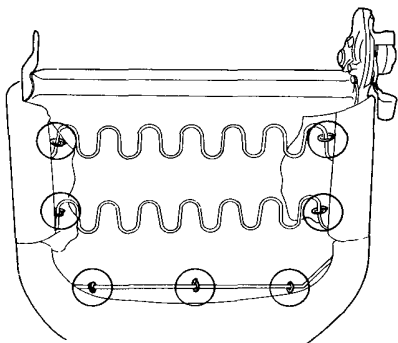
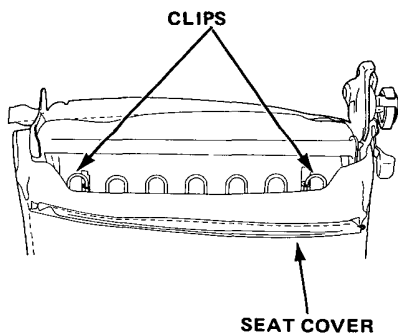
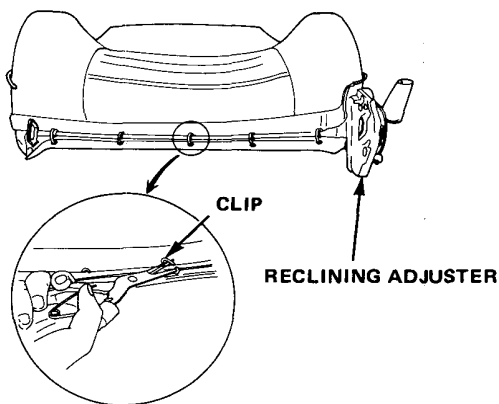

### Front Seat Cushion:

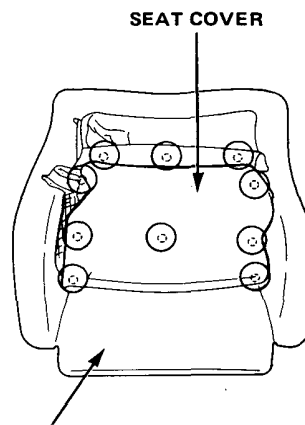
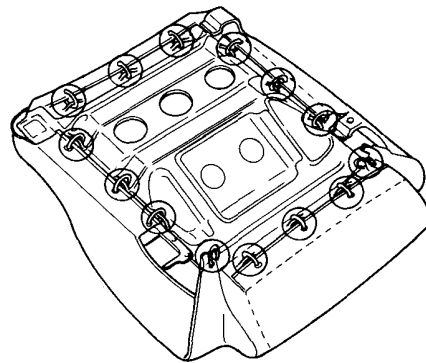

3. Remove the rear seat cover by same method.

**NOTE:** To prevent wrinkles when installing a seat cover, make sure the material is stretched evenly over the frame before securing all the clips.



# Front Seat Belts

## Replacement

**CAUTION:** Check the seat belts for damage (see page 22-76), and replace them if necessary. Be careful not to damage them during removal and installation.

1. Remove the quarter trim panel (for Coupe and 2D H/B), or the center pillar lower trim (for 4D and 4D H/B).
2. Remove the upper anchor bolt, lower anchor bolt and retractor bolt with a 17 mm socket or box-end wrench.

**NOTE:** Exercise utmost care to remove the anchor bolt together with collar, washer, etc.

3. Slide the front seat forward until the seat belt center anchor bolt is accessible, then remove the bolt and the center anchor.

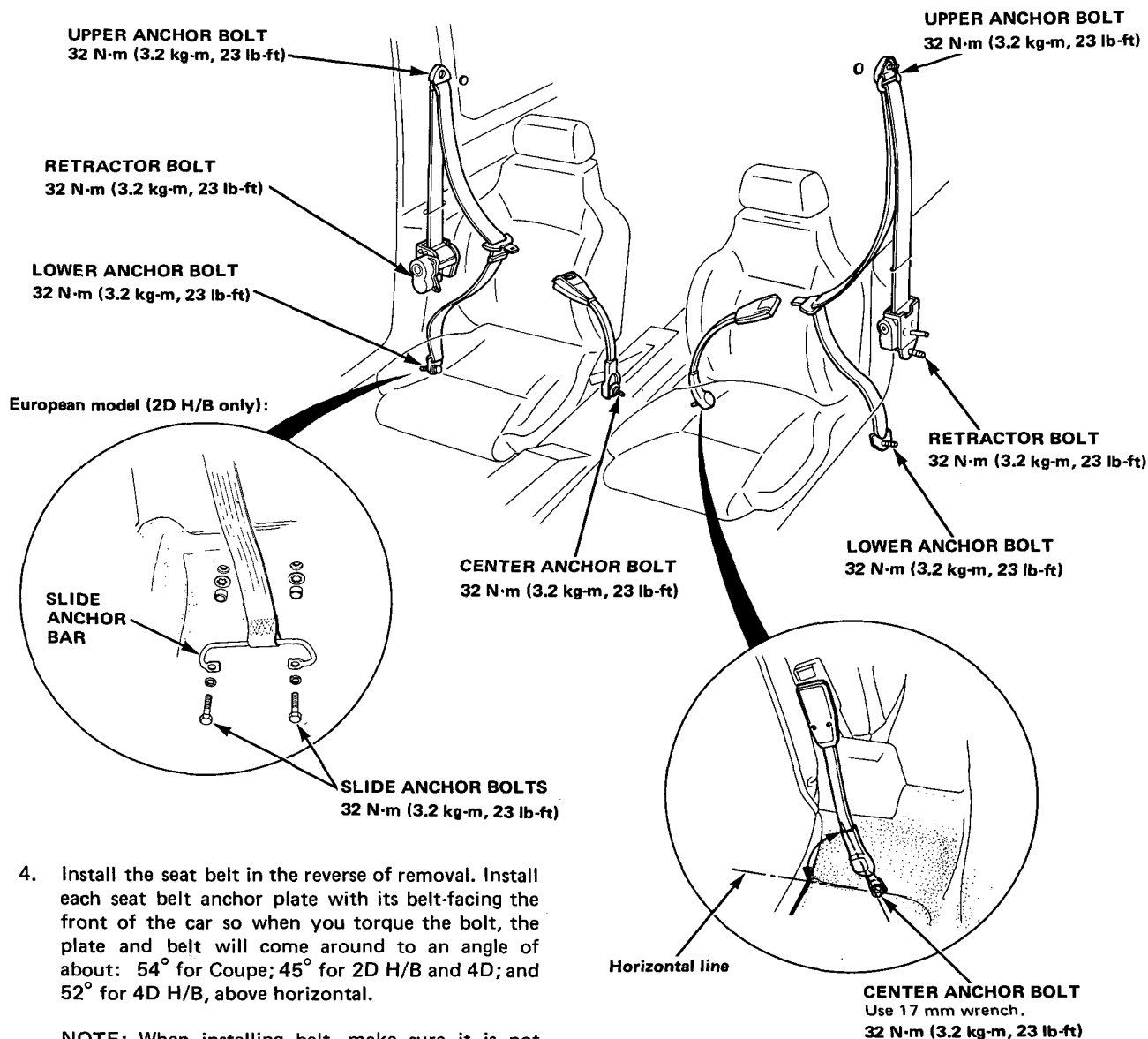

4. Install the seat belt in the reverse of removal. Install each seat belt anchor plate with its belt-facing the front of the car so when you torque the bolt, the plate and belt will come around to an angle of about: 54° for Coupe; 45° for 2D H/B and 4D; and 52° for 4D H/B, above horizontal.

**NOTE:** When installing belt, make sure it is not twisted behind the seat.

# Rear Seat Belts

## Replacement

**CAUTION:** Check the seat belts for damage (see page 22-76), and replace them if necessary. Be careful not to damage them during removal and installation.

1. To remove the rear seat belt, first remove the:
  - Rear seat (page 22-67 to 71).
  - Quarter trim panel (2D H/B: 3-point retractable type only) (page 22-62).
  - Luggage compartment side trim panel (4D H/B: 3-point retractable type only) (page 22-64).
  - Seat belt garnish (4D H/B only) (page 22-71).

2. Remove each anchor bolts and retractor bolts with a 17 mm socket or box-end wrench.

**NOTE:** Exercise utmost care to remove the anchor bolt together with collar, washer, etc.

3. Install the seat belt in the reverse order of removal.

### Coupe, 2D H/B, and 4D:

Two-point manual type (2 men)

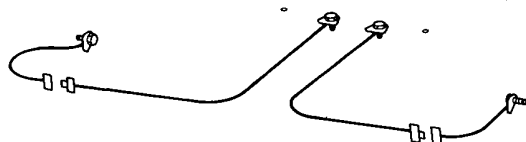

Three-point retractable type (2 men)

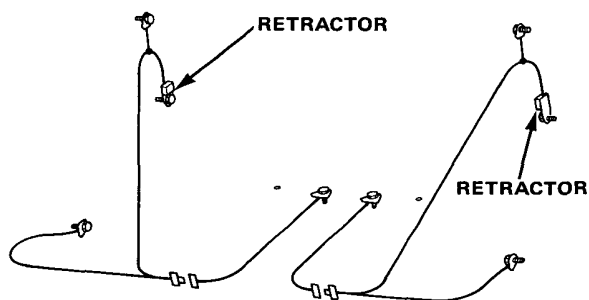

Two-point manual type (3 men)

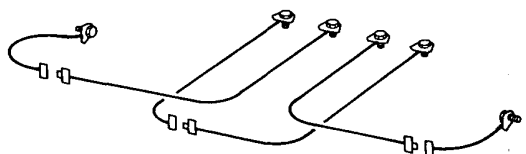

Three-point retractable type (3 men)

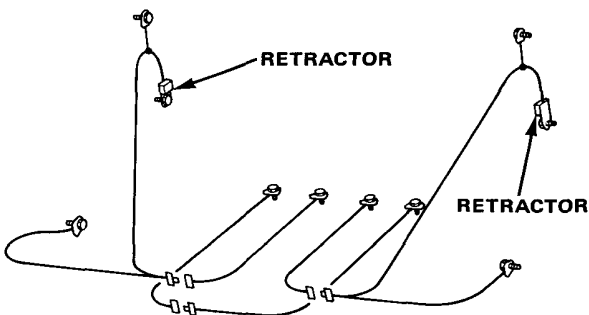

Two-point retractable type (3 men)

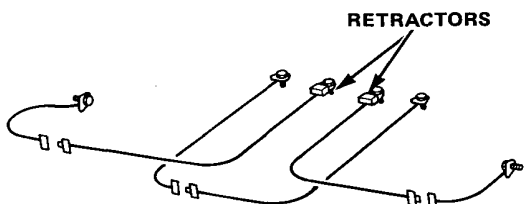



## 4D H/B:

Two-point manual type (2 men)

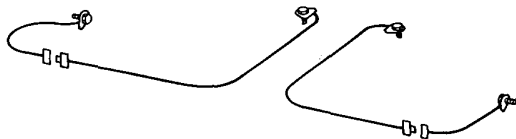

Two-point manual type (3 men)

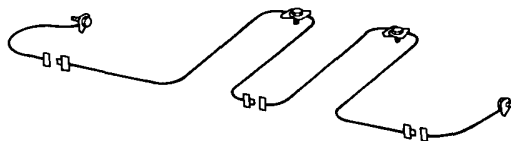

Two-point retractable type (3 men)

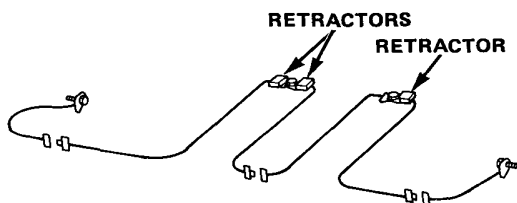

Three-point retractable type (3 men)

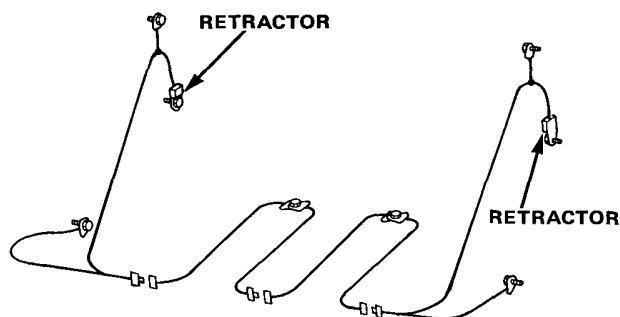

Each seat belt anchor bolt  
Tightening torque: 32 N·m (3.2 kg-m, 23 lb-ft)

4. Pass the seat belts through the:
  - Passage hole of the seat cushion (For Coupe and 2D H/B-adjustable seat only).
  - Passage hole of the seat belt garnish (For 4D H/B).
5. Install each seat belt anchor plate with its belt facing the front of the car so when you torque the bolt, the plate and belt will come around to an angle of about: 48° for Coupe; 45° for 2D H/B and 4D, above horizontal, for 4D H/B, insert the anchor plate's pin into the body hole.
6. When installing belt, make sure it is not twisted behind the seat.

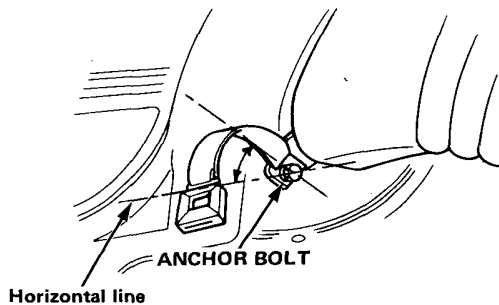
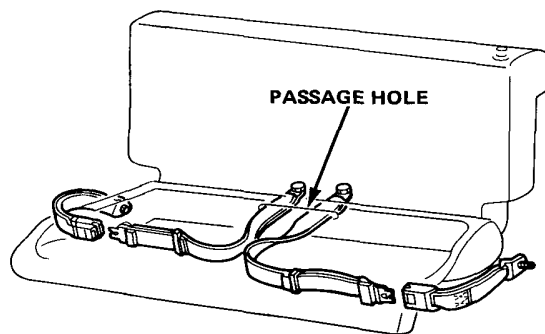

# Seat Belts

## Inspection

### Retractor Inspection

1. With the retractor installed, check that the belt can be pulled out freely.
2. Make sure that the belt does not lock when the retractor is leaned slowly up to  $15^{\circ}$  from the mounted position. The belt should lock when the retractor is leaned over  $45^{\circ}$ .

**CAUTION:** Do not attempt to disassemble the retractor.

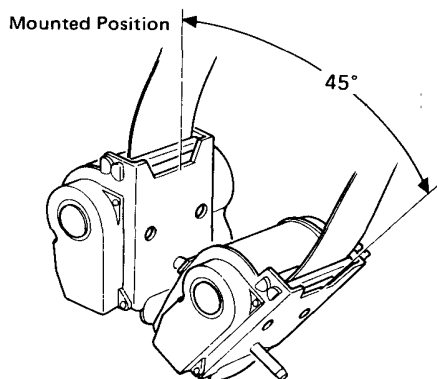

3. Replace the belt with a new one if there is any abnormality.

### On the Car-Belt Inspection

1. Check that the belt is not twisted or caught on anything.
2. After installing the anchors, check for free movement on its retaining bolt. If necessary, remove the bolt and check that the washers and other parts are not damaged or are installed properly.
3. Check the belts for fouling, damage or discoloration. Clean with a shop towel if fouled.
4. Check that the belt is not locked when pulled out slowly. The belt is designed to lock only during a sudden stop or impact (Except Canadian model).
5. Make sure that the belt will retract automatically when released.
6. Replace the belt with a new one if there is any abnormality.

# Rear View Mirror

## Replacement

1. Remove the rubber damper.
2. Slide the mirror back to remove it.

**CAUTION:** Do not use a hammer or excessive force to free the mirror from the base, plastic tabs in the base are designed to break away under sudden impact.

3. Unscrew the two screws and then remove the mirror base.

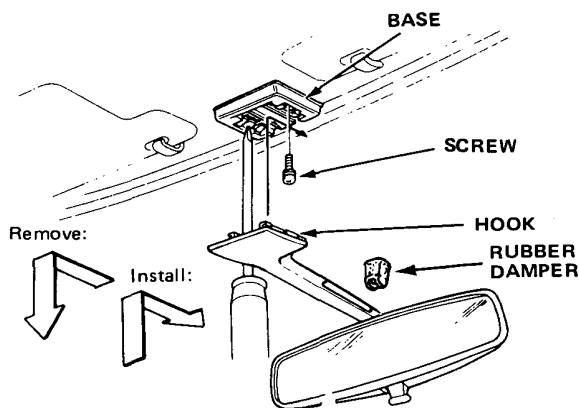

4. Install the mirror base, with the cutout toward the windshield.
5. Install the mirror by inserting its hooks in the base and sliding the mirror forward to lock it in place.

**CAUTION:** Installation is in the reverse order of removal, but take care that the tip of the mirror hook is not pushed beyond the front edge of the base. If this happens the mirror base will break.



# Console

## Replacement

1. Remove the gear shift knob (5-speed) or selector lever handle (automatic).
2. On console box equipped model, remove the mounting screws to release the front console.
3. Remove the center cap and rear lid for the center and rear console, and remove its mounting screws to release the center and rear console.

**Coupe, 2D H/B, and 4D:**

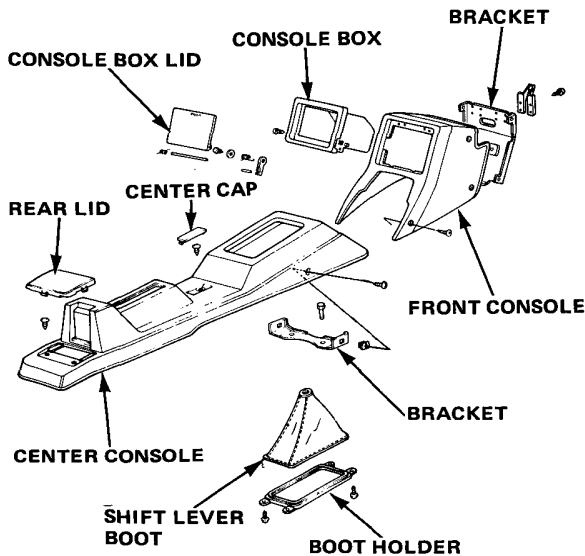

**4D H/B:**

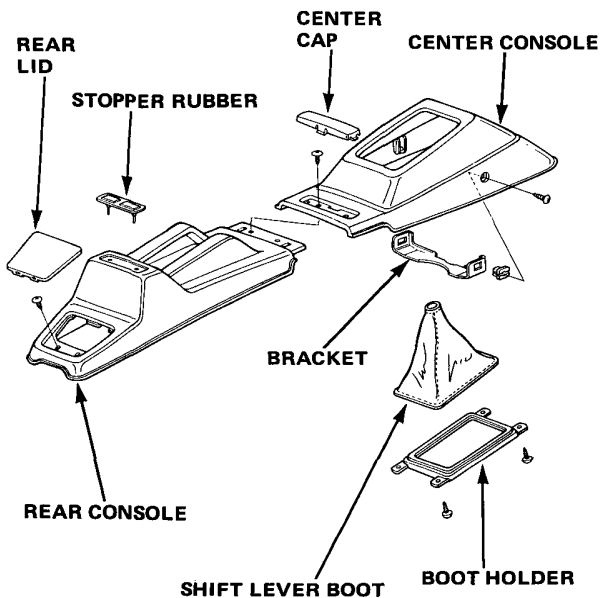

# Roof Console Trunk Box



## Roof Console Replacement

To remove the roof console, first remove the interior light and the rear view mirror.

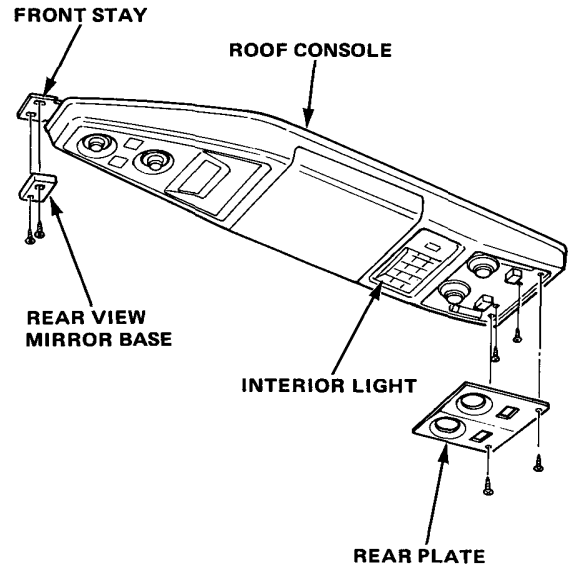

## Trunk Box Replacement (4D H/B)

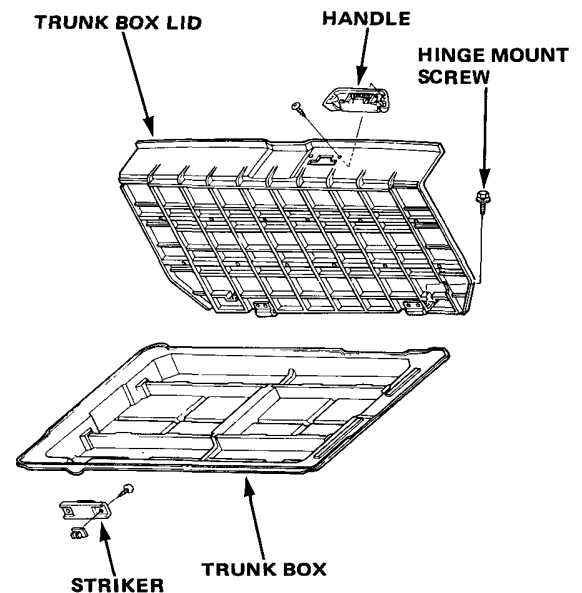

# Carpet

## Replacement

### 1. Remove:

- Front seats.
- Rear seat cushion.
- Center console.
- Right and left kick panels.
- Door sill moldings.
- Trunk lid opener.
- Right and left quarter trim panels (Coupe and 4D H/B)
- Front seat belt floor anchor bolts.
- PGM-FI control unit (Coupe only).
- Right and left center pillar lower trims (4D and 4D H/B).
- Seat hinge base covers (4D H/B only).

### 2. Pry out the clips at the rear edge and under the dashboard, and remove the carpet.

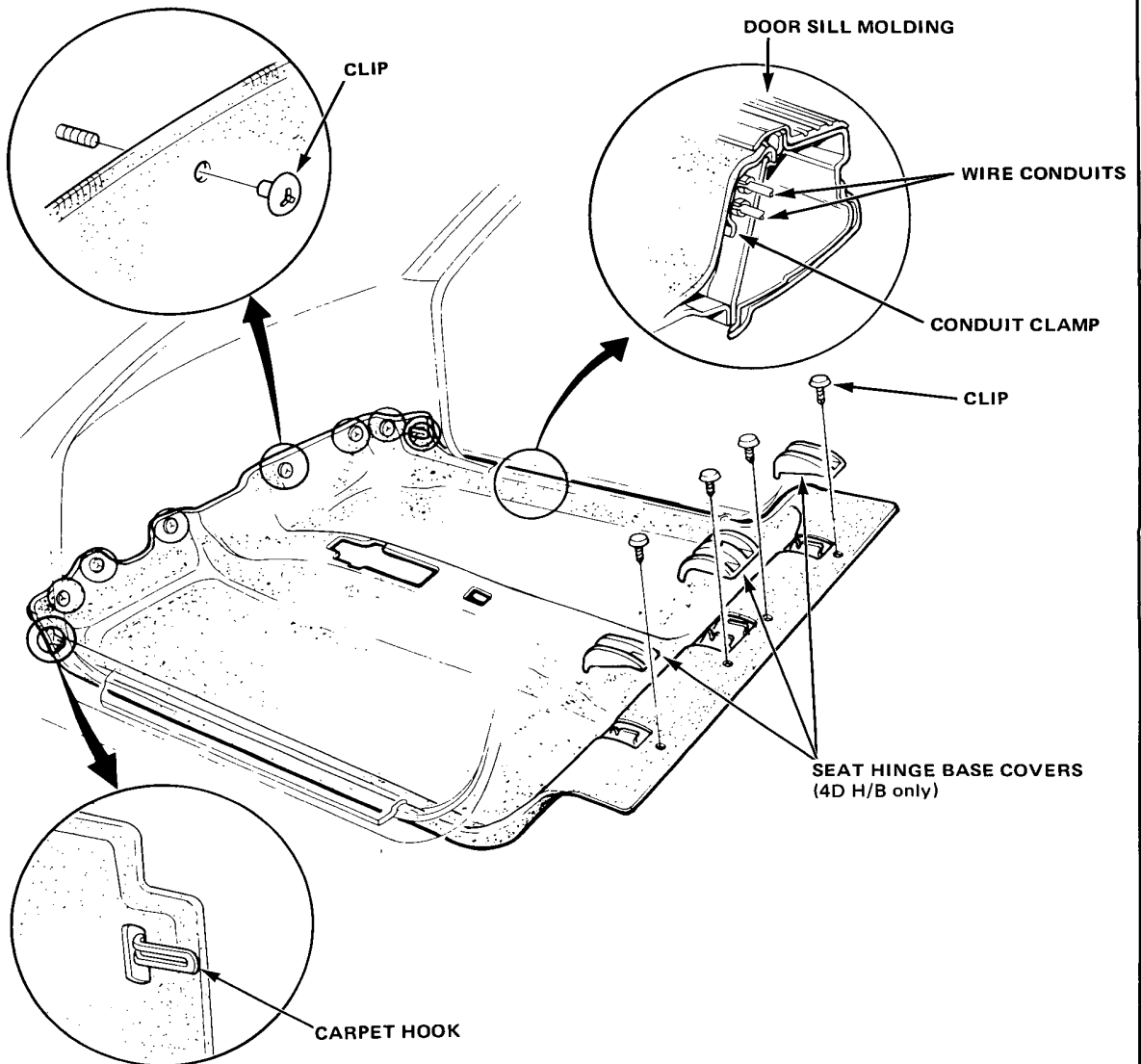

# Headliner

## Replacement



### 1. Remove:

- Sunvisors.
- Rear view mirror and base.
- Front pillar trims.
- Interior light.
- Quarter window trim (except 4D).
- Luggage light.
- Headliner side molding (4D and 4D H/B).
- Rear roof trim.
- Grab handle.
- Roof console (equipped model).
- Roof trim (Sunroof equipped model).

### 2. Remove the rear roof trim and the clips, then remove the headliner.

